

Congratulations on your purchase of an Instech animal infusion swivel. We think you will find it to be the finest swivel available anywhere.

This manual describes simple operating and maintenance procedures that will help keep your swivel in peak condition through hundreds of uses.

#### LIFETIME WARRANTY

If this 375-series single channel stainless steel swivel should fail to function properly when used under normal conditions and when cared for as described herein, return it to Instech for repair or replacement at no charge. Damage from mishandling or plugged channel are not covered by this warranty.

1.

#### USE

This precision swivel was designed to provide unlimited rotation for animals undergoing tethered IV infusion. Fluids passing through the swivel touch only Teflon and stainless steel. Unique self-adjusting seals help prevent leaks over the life of the swivel.

Swivels should be firmly affixed outside the cage in a position that will give the tethered animal the greatest range of movement. If your cage is not equipped with a swivel mount, call Instech for information on our range of mounts.

2.

The universal clamp provided with the swivel is compatible with spring stock (used to protect the cannula) from 0.08" to 0.2" OD. Use the 0.050" Allen wrench to attach the clamp to the bottom of the swivel and to tighten the V-block mount around the tether.

Attach your cannula to the bottom of the swivel and loop it around and down through the top of the spring tether.

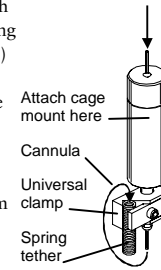

3.

#### CLEANING AFTER EVERY USE

Swivels should be cleaned after each use so that salt crystals do not form and damage the seals.

- Use a syringe to suck water, alcohol, or sterilizing solutions back through the swivel. (Pulling fluids into a syringe is more gentle than forcing them out. Never use a pump to purge your swivel.)
- Next, dry the insides by using the syringe to pull air through the swivel.
- You can autoclave these swivels, if desired.

4.

## TAKING THE SWIVEL APART

Assuming you clean it after each use, you will rarely need to disassemble the swivel. If it no longer turns freely, you can unscrew the swivel and clean the individual parts with hot water and detergent or a short dunk in an ultrasonic bath. At all times take care not to scratch or deform the white Teflon seal.

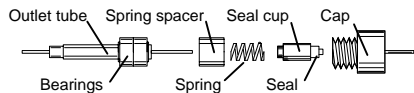

5.

Rinse and dry all parts prior to reassembly. The bearings, if washed, must be oiled with a light machine oil and blown dry again.

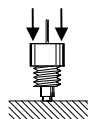

If the Teflon seal has failed, tighten it while the swivel is disassembled: (1) place the seal into the seal cup and the combination into the cap; (2) press the assembly down onto a flat surface as shown. This will force the seal against the interior of the cup and slightly reduce the diameter of the hole in the seal. Repeat this procedure for the other

6.

end of the seal. Test the seal for a snug fit by slipping it over the outlet tube.

## FOR MORE INFORMATION

Contact us at 800-443-4227 or through our website, [www.instechlabs.com](http://www.instechlabs.com). Ask for information on other Instech products:

- Dual channel swivels
- Infusion pumps and auto-sampling devices
- Harness, button and head block tethers
- Cage mounts and other accessories.

3/12/02 375sman.doc

7.

# INSTECH

INSTRUCTION MANUAL  
Stainless Steel Single Channel Swivels

Instech Laboratories, Inc.  
5209 Militia Hill Road  
Plymouth Meeting, PA 19462-1216 USA  
800-443-4227 • 610-941-0132  
610-941-0134 (fax)  
[www.instechlabs.com](http://www.instechlabs.com)